



SADLER

POWER TRAIN
TRUCK PARTS & SERVICE

Steering & **S**uspension **S**olutions





Signs your commercial vehicle needs new shocks

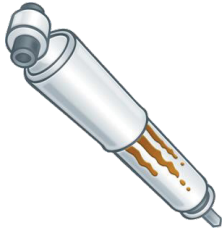

Fluid leaking from the unit



Physical Damage



Uneven Tire Wear



Leaf Spring Replacement



Mileage Replacement Recommendation

MONROE MAGNUM SHOCKS

PART#	APPLICATION	OE#
F66502	HENDRICKSON	A14496
F65416	HENDRICKSON	A20889
F65490	FREIGHTLINER	1613957000, 1615817000, 680339
F65495	KENWORTH, PETERBILT	665828, C711002, 665752, C716000
F66893	RIDEWELL	AS563B, S6009B
F65419	HENDRICKSON	A14583, A1667, A1668, A20001, A20002
F65492	INTERNATIONAL	3573265C1, 3586883C1, 3620395C1, 4050340C1
F66608	FREIGHTLINER	90044162
F65468	PETERBILT	308781, 665826, 671091
F65148	FREIGHTLINER	1012703000, 1012704000, 1013063000, 1013021000
F65404	KENWORTH, MACK	680476, 680486, 650404
F65101	PETERBILT	0201787, 202737, 202742, 665655, B716009
F65405	MACK	650405, 8056892
F65102	KENWORTH, MACK	K37411, K37416, K37426, K37427, 650102, 665453, 665670, 675122, 25632145
F66636	FREIGHTLINER	1398980
F66884	MACK	14QK410M, 14QK410M3, 25625234, 25625254
F65409	VOLVO	3945819
F66866	KENWORTH	90044089
F65436	FREIGHTLINER, KENWORTH	1618103000, 481700000493, 665903, 665944, 70701
F66627	HENDRICKSON	85045, S23651, 665733, 665760, 665767, B22311, B22862, B23651

The ContiTech premium brand offers you:

- 100 % OE quality
- Global availability
- Complete OEM range, also for the aftermarket
- Precisely configured suspension characteristics
- Maximum service life
- Maximum load capacity
- Simple and precise fitting
- ContiTech air spring range



Even original-looking counterfeit reproductions air springs are not up to the standards of a safety-critical product. When subjected to service loads and real operating conditions, the difference from the original quality product quickly becomes apparent.

PART#	OE#	APPLICATION	STYLE	MIN HEIGHT	MAX HEIGHT
AS-8453	S20900	HENDRICKSON	ROLLING LOBE	5.9	19.3
AS-8382	16-13810-000	FREIGHTLINER	ROLLING LOBE	8.75	23
AS-8930	90557332	NEWAY	ROLLING LOBE	7.3	23
AB1DK23I-8813	C811003	KENWORTH, PETERBILT	ROLLING LOBE	7.1	18.9
AS-8382P	16-13810-000	FREIGHTLINER	ROLLING LOBE	8.3	23
AS-8312	301649	PETERBILT	ROLLING LOBE	7.6	18.9
AB1DK23L-8864	03-08716	PETERBILT	ROLLING LOBE	7.8	25.2
AS-8434	C20127	HENDRICKSON	ROLLING LOBE	7.5	24.6
AS-4525	S14487	HENDRICKSON	TRIPLE CONVOLUTED	4.6	16.9
AS-4505	3098608	VOLVO	DOUBLE CONVOLUTED	3.1	10.8
AS-81067	350243C94	NAVISTAR	ROLLING LOBE	6.9	24.3
AS-8888	905-57-369	NEWAY	ROLLING LOBE	7.3	23.3
AS-8451	50899001	HENDRICKSON	ROLLING LOBE	7.5	22.9
AS-8523	C20901	HENDRICKSON	ROLLING LOBE	5.1	19.3
AS-8537	K30322	KENWORTH	ROLLING LOBE	3.9	11.4
AS-8433	C20010	HENDRICKSON	ROLLING LOBE	5.5	17.7
AS-8565	S23612	HENDRICKSON	ROLLING LOBE	9.2	29.5
AS-8548	90557157	NEWAY	ROLLING LOBE	7.3	23
AS-4524	C23114	HENDRICKSON	DOUBLE CONVOLUTED	3.1	11.6
AS-8871	1001R13109G	RIDEWELL	ROLLING LOBE	5.4	17.7

AIR SPRINGS

What to look for in a quality spring

- Leaves are properly aligned to one another, both laterally and vertically.
- On multi-leaf springs, no excessive gaps between leaves and no excessive scaling on the top leaf.
For front tapered springs, a uniform gap between the leaves from the center section to the end of the spring. This is required to provide proper performance and durability
- Coated with corrosion protection.
- Spring leaves are properly stepped for the most efficient load carrying weight ratios. If the leaves are the same thickness, the steps should be equal.



PART#	APPLICATION	DESCRIPTION	CAPACITY	OE#
75-212	PETERBILT	FRONT, FULL TAPER	5400	0202177
50-267	HENDRICKSON	REAR, MULTI-LEAF	15500	45027000
59-548	KENWORTH	FRONT, FULL TAPER	6000	B816012001
43-1261	FORD F250 '99-07	REAR	2500	F81A5560BE
43-698	FORD A, AT, L, LT '96	FRONT	9200	F6HT5310ACA
46-1295	FREIGHTLINER TUFTRAC	REAR	20000	A1615726000
59-524	KENWORTH	FRONT, FULL TAPER	7200	B811006
46-1319HD	FREIGHTLINER M2	REAR	14000	-
46-1355	FREIGHTLINER	REAR	30000	A1614413000
46-1770	FREIGHTLINER FLC112	FRONT	10000	A1617418000
62-147	MACK SS 40K-44K	REAR	19000	25192116
55-1217	INTERNATIONAL 3200-8600	REAR	10400	3534537C91
22-1269	CHEVROLET SILVERADO 1500/2500/3500 '99	REAR	2025	15711753
62-115	MACK	REAR	19000	4QK3286
46-1764	FREIGHTLINER FLC112	FRONT	9100	A1617193000

LEAF SPRINGS

U-BOLT TORQUE CHART

SIZE (dia. x thread)	TORQUE (ft. lbs.)	SIZE (dia. x thread)	TORQUE (ft. lbs.)
1/2 x 20	66 - 84	3/4 x 16	279 - 330
9/16 x 18	93 - 116	7/8 x 14	441 - 511
5/8 x 18	129 - 157	1 x 14	665 - 757
3/4 x 16	223 - 264	1-1/8 x 12	943 - 1059
7/8 x 14	353 - 409	1-1/4 x 12	1300 - 1443

Retorque after 500 miles & recheck torque periodically



SERVICE SMARTS





MACK TRUNNION STANDS

- Making installation easier, saving time and labor
- Pre-stressed for a straighter, flatter mounting surface to help eliminate frame rail bow misalignment
- Cross shaft machined to the tightest tolerances and less bolt pattern alignment issues
- Made in the USA



PART#	CROSS REFERENCE	SUSPENSION CAPACITY
MCK21	97QL5119M	44/48K
MCK23	97QL585	44/48K

	SQUARE PATTERN	TRAPEZOID PATTERN
1/4 INCH	MCK28	MCK29
3/8 INCH	MCK30	MCK31

HEIGHT CONTROL VALVES



PART#	STYLE	INTEGRAL DUMP	APPLICATION	CROSS REFERENCE
171.H102	BARNSDALE	YES	FREIGHTLINER	16-14318-000
755050	BARNSDALE	NO	HENDRICKSON TRAILER	VS227
E9624	HADLEY	YES	INTERNATIONAL	H500C
3726	BARNSDALE	YES	HENDRICKSON	57977-000
S4640070040	WABCO	NO	INTERNATIONAL & PETE	S4640070040
90054007	HALDEX	NO	MULTIPLE	90054007



PART# SCT08EBBKAX2X

COMPOSILITE® SCT08

✓ in stock

Light Duty Steerable
The COMPOSILITE® SCT08 offers a reduced system weight up to 24 pounds and a minimized package space of 22.1 inches. Hendrickson has taken tie-rod technology one step further by introducing the patent-pending Compliant Tie Rod (CTR)Technology



PART# SCT13C04XBAX1X

COMPOSILITE® SCT13

✓ in stock

Lightweight Steerable Suspension System
The COMPOSILITE® SCT13 offers a reduced system weight up to 69 pounds and a minimized package space of 22.1 inches. Hendrickson has taken tie-rod technology one step further by introducing the patent-pending Compliant Tie Rod (CTR) Technology



INTRAAX®

TRAILER:
VOCATIONAL
AAT 23K/25K/30K
Top Mount



VAN'TRAAX®

TRAILER: ON-HIGHWAY
Integrated Slider
Suspension



HT™ SERIES

TRAILER:
VOCATIONAL
Top Mount



AIRTEK®

ON-HIGHWAY
Integrated Front Air
Suspension & Steer
Axle System



HAULMAAX®

VOCATIONAL
Heavy Duty
Rubber Suspension



HN®

VOCATIONAL
VariRate Spring
System



RT/RTE™

VOCATIONAL
Steel Leaf Spring
Suspension



COMFORT AIR®

BUS/RV/MEDIUM
DUTY
10K Single Axle Rear
Suspension



Your headquarters for all makes and models of re-manufactured steering gears, pumps and cylinders

Medium and Heavy-Duty Trucks | School Buses | Fire | Garbage Trucks | Farm | Construction Equipment



Sheppard Early Series:
292, 372, 392,
491, 492, 592



Sheppard 'M' Series:
M60, M80, M90,
M100, M110



Ross Series of Gears:
HF54, HF64,
HFB64, HFB52,
TAS, HFB70, THP

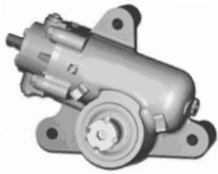

Ross Series of Gears:
MD83, HD94,
SD110, XD120



Steering Pumps:
Eaton, Saginaw,
Vickers, TRW,
ZF, LuK



Steering Cylinders:
Eaton,
Saginaw,
Vickers, TRW,
ZF, LuK

TIGER TOOL



**7/8" - 14 Tie Rod
End Remover**
PART# 10301



**Sheppard M100
Pitman Arm Puller**
PART# 10385



**Sheppard M110
Pitman Arm Puller**
PART# 10389



TIE ROD ENDS



PART #	APPLICATION	MERITOR #	DAYTON #
ES423L	DANA/SPICER 160S-1200S LH THREAD	R230068	310-222
ES423R	DANA/SPICER 160S-1200S RH THREAD	R230069	310-223
ES2090L	DANA/SPICER I50-I132 LH THREAD	R230072	310-433
ES2091R	DANA/SPICER I50-I132 RH THREAD	R230073	310-434

STEERING



QWIKIT KING PINS

Install faster than reamed king pins
Optimal Lubrication – No-Ream steel bushings and pins are grooved to provide an optimal stream-of lubrication to high-wear areas



PLUSKIT KING PINS

For No-Ream installation, perfect fit, less down time and better quality
Pre-Sized Bronze Bushings:
Have a fit as good as “reamed” without the expense

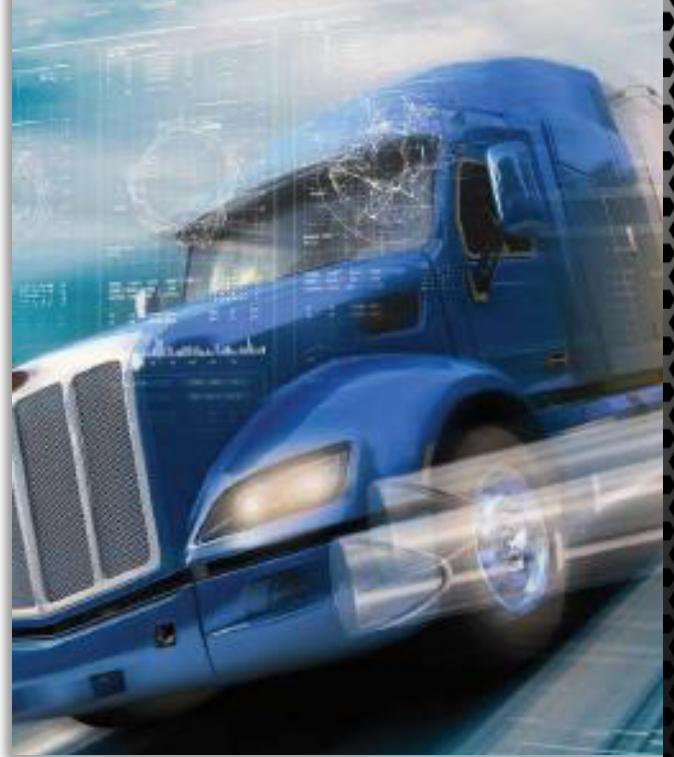

MAKE	QWIK KIT #	PLUS KIT #	AXLE CODE	OE KIT #	OE PIN SPECS	LIP SEAL INSTALLATION TOOL
MERITOR	K961L	70.961.12	FD-961; FD-965; FF-941; FF-942; FF-943; FF-944; FF-945; FF-961; FF-962; FF-966; FF-967; FC-965; MFS-10; MFS-12122A; MFS-12143A; MFS-12153A	R201315; R201470	1.794 x 10.40	ST70-7
SPICER / DANA / EATON	K147E	70.147.05	02-AEZ; 02-AGB; 02-AGC; 02-AGE; E1002I/W; E1202I/W; E1322I/W; E1462I/W	328347; 328349	1.872 x 9.05	ST70-23
SPICER / DANA / EATON	K120I	70.120.09	02-ADC; 02-ADL; 02-ADD; 02-ADG; 02-AND; 02-ADP; I-100S; I-100SA; I-100SG	1668411C91; 120KK100	1.921 x 9.87	ST70-19
SPICER / DANA / EATON	K102I	70.102.09	02-ADA; 02-ADB; 02-ADV; 02-ADW; 02-AEM; D800; I-60S; I-60SG; I-61	166027C91; 101KK111	1.359 x 7.98	ST70-2
SPICER / DANA / EATON	K103S	70.103.19	02-AEM; 02-AHA; 02-AGZ; 02-ADZ; 02-AGN; D600; D700; D850; D800F	329182	1.359 x 7.97	ST70-2
MERITOR	K981R	70.981.18	FF-981; FF-982; FF-983; FF-984; FF-986; FF-987; MFS-12122D; MFS-12143D; MFS-12144D; MFS-13122D; MFS-13143D; MFS-13144D	R201419; R201472	1.794 x 8.84	ST70-7
SPICER / DANA / EATON	K120E	70.120.05	02-AEA; EFA10F5; EFA12F4; EFA13F5	806355; 815984; 1008431	1.625 x 9.19	ST70-6



Cedar Rapids
800-383-8238

Davenport
800-383-4213

Dubuque
800-747-0752

Waterloo
800-373-3035